



JSC "Asaka Obi non "

[55]

- Specialization- production of bread and confectionary
- Location- Andijan Region, Asaka District
- Capacity- 5 tons per day
- Total area occupied- 1,8 hectares
- Area occupied by buildings- 1,2 hectares
- Facilities- infrastructure- 100 per cent
labor - 100 per cent
- Terms of sale- complex (suite)
- Equipment- Austria- Bulgaria, deterioration - 20 per cent
- Starting price- USD 400,7 thousand



JSC "Asaka Obi non"

[56]

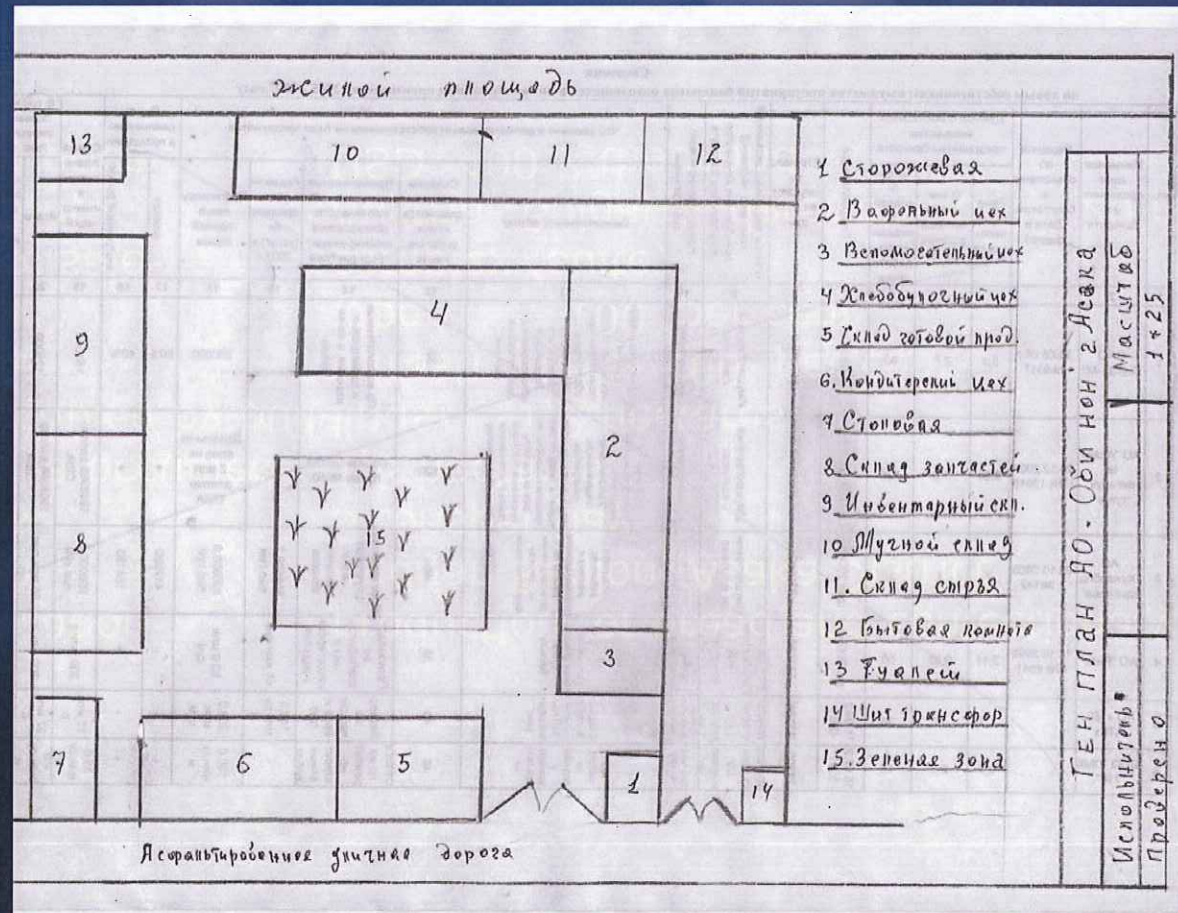



JSC "Asaka Obi non "

[57]

